



TEMPORARY USE PERMIT RENEWAL NO. TUP00024

COASTLAND WOOD INDUSTRIES LTD.

Name of Owner(s) of Land (Permittee)

301 EATON STREET

Civic Address

1. This Temporary Use Permit ('Permit') Renewal is issued subject to compliance with all of the bylaws of the Municipality applicable thereto, except as specifically varied or supplemented by this permit.
2. This Permit applies to and only to those lands within the Municipality described below, and any and all building structures and other developments thereon:

Legal Description:

Lot A, Section 1, Nanaimo District, Plan VIP74056

PID: 025-455-249

3. The land described herein shall be used strictly in accordance with the following Terms and Conditions and provisions of this permit and any plans and specifications hereto which shall form a part thereof:
 - a) This Permit authorizes the use of the subject property, as identified on Schedule A, for the use of "processing, distribution and onsite sales of firewood with an accessory office" from February 9, 2021 to February 9, 2024.
 - b) The subject property shall be developed in accordance with the Site Plan received 2020-JUN-29 as shown on Schedule B.
 - c) Hours of operation shall be limited to normal business hours.
 - d) Upon expiry of this Temporary Use Permit, and if no rezoning and Official Community Plan amendment is approved, the use must immediately cease and all structures and debris must be removed from the subject property within 30 days.

4. This Permit is not a business license nor does it constitute approval of any signage. Separate applications must be made for a business license and a sign permit.

REVIEWED AND APPROVED ON

2021-FEB-9

[Signature]

Dale Lindsay, General Manager
Development Services

*Pursuant to Section 154 (1)(b) of the Community Charter
Pursuant to Section 493(3) of the Local Government Act*

Schedule A

The map displays a residential area with the following streets and lot numbers:

- Centre St** (top edge)
- South St** (left edge)
- Harbour View St** (bottom left edge)
- Strickland St** (bottom left edge, intersecting Harbour View St)
- Island Highway S** (bottom edge, running diagonally)
- Haliburton St** (middle left edge, running diagonally)
- Woodhouse St** (middle right edge, running horizontally)
- Eaton St** (right edge, running vertically)

Highlighted Residential Zones (in blue):

- R2:** Located on the left side of the map, near the intersection of Centre St and South St.
- COR3:** Located on the left side of the map, near the intersection of Centre St and South St.
- R1:** Located in the center of the map, near the intersection of Haliburton St and Woodhouse St.
- R4:** Located on the left side of the map, near the intersection of Centre St and South St.
- R6:** Located on the right side of the map, near the intersection of Centre St and Eaton St.
- CC1:** Located on the right side of the map, near the intersection of Centre St and Eaton St.
- R8:** Located on the bottom right side of the map, near the intersection of Island Highway S and Eaton St.

Lot Numbers:

- Left Side (near Centre St):** 122, 124, 128, 132, 134, 138, 140, 142, 144, 160, 186, 190, 198.
- Top Left (near Centre St):** 720, 724, 726, 728, 736.
- Top Center (near Centre St):** 719, 723, 727, 731, 733, 735, 737, 739, 741, 745, 110.
- Top Right (near Centre St):** 718, 722, 724, 726, 730, 734, 740, 742, 746, 750.
- Right Side (near Centre St):** 719, 721, 725, 729, 733, 739, 743, 745, 751, 233, 291.
- Bottom Left (near South St):** 51, 210, 212, 804, 808, 812, 814, 820, 824.
- Bottom Center (near Island Highway S):** 809, 857, 877.
- Bottom Right (near Eaton St):** 217, 221, 225, 301, 791, 821.

 **Subject Property**

LEGAL: LOT A, SECTION 1, NANAIMO DISTRICT, PLAN VIP74056

SITE PLAN

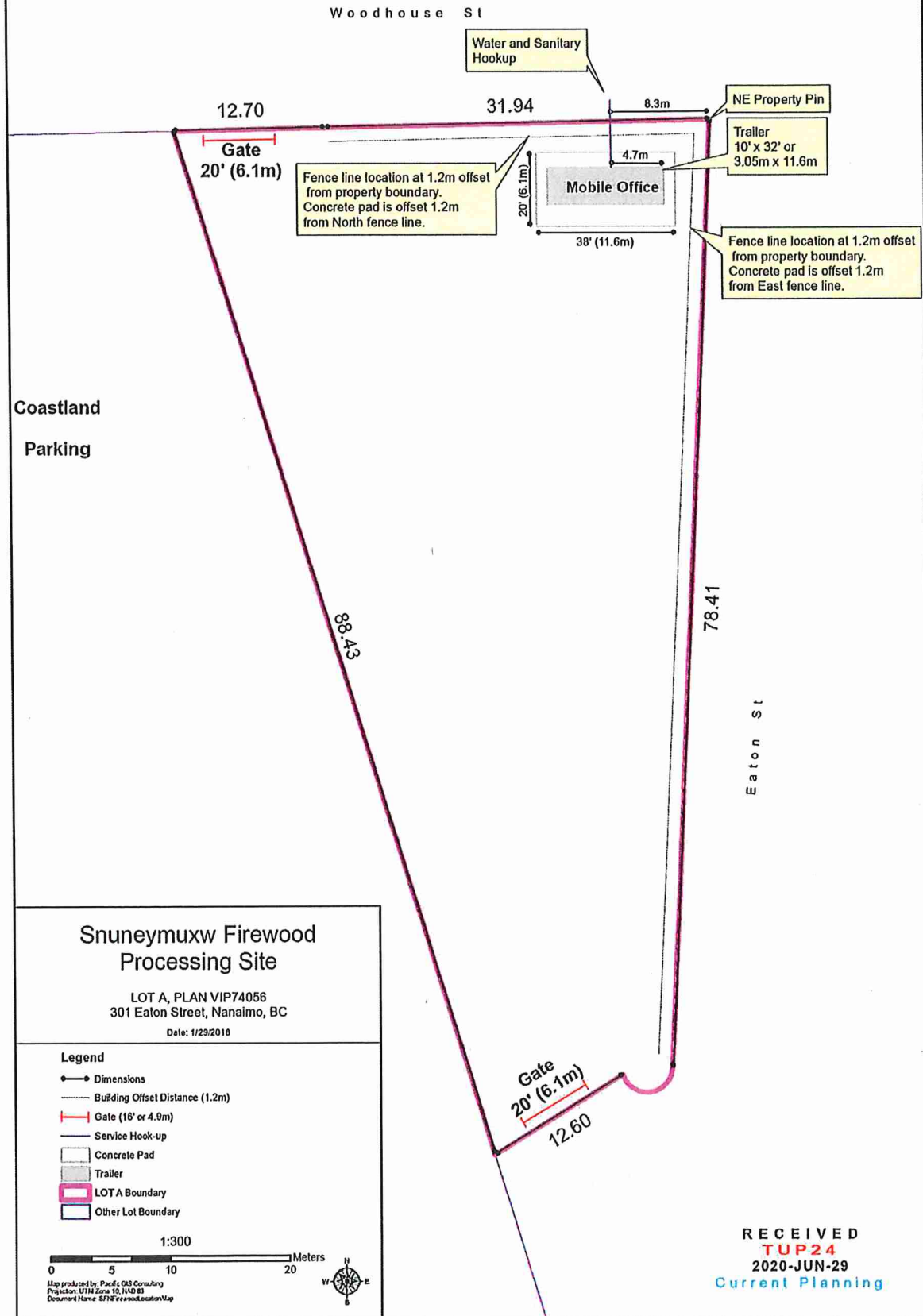

Temporary Use Permit TUP00024
301 Eaton Street

Schedule C

BUILDING ELEVATION

